

0.0 Data:

0.1. Name:

Sri Siddha primary school ó Dakchu.

0.2. Drawing:

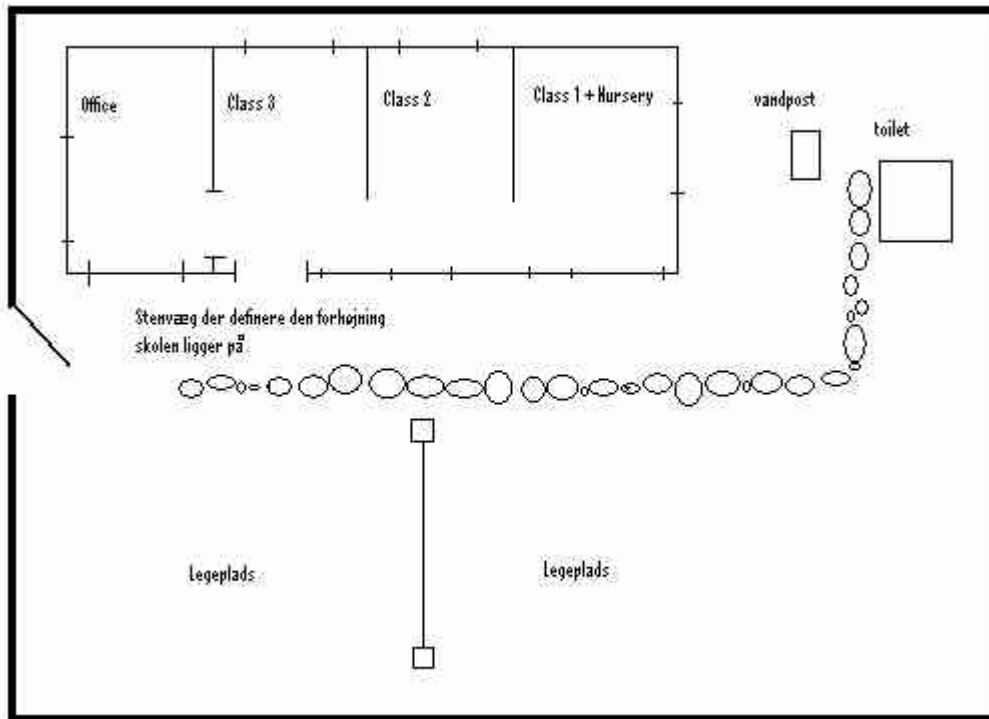

Not in scale.

0.3. Participants:

Headmaster Lakpha Sherpa.

SMC member Ang Pasang Sherpa.

Ang Tsering, chairman of the SMC at the larger Sagar Bakanje School. His experience is helpful to the SMC at Dakchu School and therefore he is an important person for the school.

1.0 School:

1.1. School History:

The school was built in 1998/2055 by a Japanese named Kurimoto. They do not remember the name of his organisation, but the donation for the school was 100.000 Rs. This was enough to build the school except for the new tinroof which is donated from Bakanje VDC in 2004/2061. The money from Kurimoto also covered toilet-facilities, playground, waterpost and compound wall.

The donation was made possible because Ang Pasang (SMC member) befriended Kurimoto when he visited Nepal. Kurimoto was donating a large amount of money to a temple in Kathmandu and Ang Pasang suggested that he instead donated money to his home village to build a school there.

1.2. Buildings:

RRN, an INGO, covered the costs for new furniture in 2006/2063 and they are still working fine. The school has a light problem as there are wooden windows (**skodder**) instead of glass. Moreover the roof is without skylight. As a result a number of the windows and the door must be open throughout the year in order to get light at all. This results in a very cold climate in the classrooms during winter as the school lies in 2900 meter. It is a problem for everyone at school, but for the poor children it is a larger problem, as they do not have enough clothes to cope with the problem. A large wish is therefore glass or plastic windows or, if possible, skylight in the tinroof. To cope with the problem the Dashain holiday

in late October start November is shortened and the winter break is from mid December to start February. At the present they have no applications for help at NGO's, INGO's or DEO. And the Bakanje VDC budget is too little to allow help for Dakchu as there are other schools as well.

1.3. Organization:

School Management Commitee:

7 members in total. Ang Pasang Sherpa is chairman. The SMC has meetings every second month.

SMC decides the rules & regulations for the school, estimates the teachers work and how the school is functioning in general. If there are any flaws in these areas the SMC will take the relevant steps to make improvement.

Parents Teacher Association:

13 members in total. The PTA has 2 meetings in a year but has no formal decision power. Their main purpose is to control that everything is functioning at school, fx that the teachers come on time, and to help when help is needed.

1.4. School Fee:

None.

1.5 Uniform:

No uniform. As a government rule uniform is only necessary from class 5 to 10.

1.6. Scholarship:

1.7. Library:

The school does not possess a library, but it has a few fairytale books. Nepali and english litterature would be welcomed.

1.8. Teaching Materials:

Nepali	Teaching books, notebooks, pencils, papers, posters and selfmade flashcards
--------	---

2.0 Teachers:

2.1. Teachers Data:

<i>Headmaster</i>		
Lakhpa Sherpa		
<i>Payed by</i>	Government	6400 Rs + 200 Rs ¹ /month
<i>Education</i>	SLC, Teachers Licens	
<i>Subjects</i>		
<i>Extra Courses</i>	20 days course from HT in teaching methods.	
<i>Hired Since</i>	2004	
<i>Experience</i>	8 years at Bakanje School	
<i>Extras</i>		

Mingma Lamu		
<i>Payed by</i>	VDC (2500 Rs) and DEO (1000 Rs)	3500 Rs/month
<i>Education</i>	SLC	
<i>Subjects</i>		
<i>Extra Courses</i>	One week gov. course in Nursery class teaching.	
<i>Hired Since</i>	2006	
<i>Experience</i>		
<i>Extras</i>	Mingma will recieve salary from VDC untill april the first 2008/2065.	

¹ Headmaster salary

After that it is unsure whether she can stay at the school as a teacher.
--

2.2. Teachers Comments:

2.3. Multiclass:

3.0 Students:

3.1. Students Data:

Age	2007	Girls	Boys	Total
3-5 år	Nursery	3	3	6
5-6 år	Class 1	2	2	4
6-9 år	Class 2	3	3	6
8-10 år	Class 3	4	5	9
	Total	12	13	25

3.2 Disciplin/interest in school:

Lakhpa finds the students motivation is satisfactory, the older they get, the better it gets. The same goes for their discipline.

3.3 Regular attendance:

3.4 Does all the children of the area attend school?

3.5 Energy Level:

At times there are problems with the energy level, but most of the time it is okay.

3.6 Lunch:

Some students do not eat lunch, but Lakhpa believes lunch to be important, so he encourages the parents to remember their childrens lunch and if they forget he will ask the other children to share their lunch.

3.7 Homework:

3.7.1 Amount of homework and percentage of the students doing it

Homework are given every day and 2-3 hours are needed to do it. The younger children have less than the older. The nursery children only receives little homework in order to create a good study habit.

Approximately 80 % do their homework and if they have not done it, it is most often because something has happened at home. However they still receive punishment in order to secure improvement. The homework consists of reading followed by reading related understanding questions, and writing or math exercises. The homework is checked at school.

3.7.2 Amount of household and farm work for the students/ Estimated influence on household work on homework

Most of the students have some light work at home before school, but the school does not consider it to be a problem.

4.0 Parents:

4.1 literacy level

There is a great difference in literacy and education level among the parents. Some have SLC, others 7-8 grade and some no schooling at all. The lack of education can result in problems as these parents are not able to help their children with the homework.

4.2 Interest in, support of and understanding of the importance of school

Lakhpa thinks that a strong relation to the parents is important and he informs the parents if there are any problems with their children.

Some of the uneducated parents may at some schooldays keep their children at home to do work instead of going to school. The parents who at times keep their children at home do so because of bad economic conditions and possibly because of a lacking understand of the schools function. The harvest and food at the table is more important than a school that may or may not give results in the future.

Other parents send their children to Chimbu School instead in the hope of receiving a scholarship or other things from HP. The large support from HP to Chimbu simply results in parents choosing

Chimbu all though they live closer to Dakchu. **Our remark: With the low number of children at Dakchu school this is a serious problem.**

4.3 any special arrangements for the parents at school

If there are any problems the SMC will gather all the parents, but in general it only happens one time a year. Approximately 75 % of the parents do volunteer work at school and or take part in the SMC.

5.0 Wishes:

1. Finansiell help to a teacher salary. Mingma is only hired until 1.4.08 with salary from VDC. Thereafter Lakhpa will be alone with four classes.
2. Separate classrooms. The noise level would be improved significantly if the rooms were divided properly. One option is stonewalls between the classrooms as opposed to the present wooden walls that do not even go from outer wall to outer wall (see drawing). If this is done the back wall must be moved in order not to make the classrooms too small. Another option would be to make the wooden walls go all the way from outer wall to outer wall with a door. Carpets could be used for noise isolation.
3. Pens and notebooks. Many of the parents have difficulties with providing this to their children.
4. A stone compound wall. They believe that the present wooden compound is not good enough to keep animals outside the school. This prevents the nursery class from planting flowers as they will be eaten.
5. A reparation of the floor. The floor is in a very bad condition. A lot of **brædder** are broken, the floor is tipping and moving when you walk on it.
6. A new toilet. They would like one for boys and one for girls as sharing the toilet sometimes causes non-specified problems.

6.0 Additional comments:

Ang Dawa (Bakanje, headmaster) has told us that Dakchu has a problem to get enough children in the coming years. During the interview Ang Tsering told us, that a local problem is that a certain amount of the parents from Dakchu, and to a certain extent Kenja and Bakanje as well, are choosing Chimbu School instead of their hometown school. The reason for this is the many scholarships awarded to the Chimbu children, the good facilities and the financial help with pencils and the like. But while Ang Dawa seemed to think that Dakchu School was about to close because of the fleeing children this is not Ang Tsering's belief. **We choose not to test the claim from Ang Dawa that Dakchu was still receiving money from the Japanese contributor.**

Jangbu Sherpa from Chimbu School holds that the reason for Ang Dawas claims, is that he wants to attract money to Bakanje. (det her nævner vi da ikke i Bakanje interviewet???)

Ang Tsering reaffirms Ang Dawas own picture of Bakanjes inactive teachers, and to a certain extent, inactive parents. Moreover he told us, that Bakanje school is teased by other schools because of their students low testing scores ó this is said without us mentioning Dawas own words in this direction.

7.0 Schoolexcursion:

8.0 Disabled: